

UCC
Cylindrical bore (with set screws)
d 12 ~ (45) mm

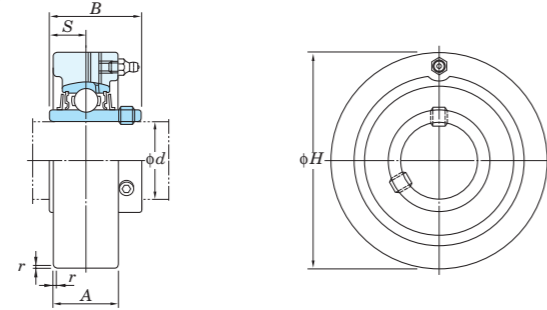

Shaft Dia. mm	inch	Dimensions inch mm					Unit No.	Housing No.	Bearing No.	Basic Load Ratings kN		Factor f ₀	Mass kg
		H	A	r	B	S				C _r	C _{0r}		
12	1/2						UCC201 UCC201-8						0.52
15	5/8	2.835	25/32	0.06	1.220	0.500	UCC202 UCC202-10	C204	UC202 UC202-10	12.8	6.65	13.2	0.50
17	3/4	72	20	1.5	31	12.7	UCC203 UCC204-12		UC203 UC204-12				0.49
20							UCC204		UC204				0.47
25	7/8	3.150	55/64	0.06	1.343	0.563	UCC205-14		UC205-14	14.0	7.85	13.9	0.64
	15/16						UCC205-15	UC205-15					
	1						UCC205-16	UC205-16					
	1						UCCX05	UCX05					
30	1 1/8	3.346	11/16	0.06	1.500	0.626	UCCX05-16	CX05	UCX05-16	19.5	11.3	13.9	1.0
	1 3/16						UCC305	UC305					
	1 1/4						UCC305-16	UC305-16					
	1 1/4						UCC206-18	UC206-18					
35	1 3/8	3.543	11/32	0.08	1.496	0.591	UCC206-19	C206	UC206-19	19.5	11.3	13.9	0.81
	1 1/2						UCC206-20	UC206-20					
	1 3/4						UCCX06	UCX06					
	1 3/4						UCCX06-19	UCX06-19					
40	1 7/8	3.937	13/16	0.08	1.689	0.689	UCCX06-20	CX06	UCX06-20	25.7	15.4	13.9	1.3
	1 7/8						UCC306	UC306					
	1 7/8						UCC207-20	UC207-20					
	1 7/8						UCC207-21	UC207-21					
45	1 7/8	4.331	1 11/32	0.08	1.937	0.748	UCC207-22	C207	UC207-22	29.1	17.8	14.0	1.7
	1 7/8						UCC207-23	UC207-23					
	1 7/8						UCCX07-22	UCX07-22					
	1 7/8						UCCX07-23	UCX07-23					
50	2	4.331	1 7/64	0.12	1.890	0.748	UCC307	C307	UC307	33.4	19.3	13.2	2.2
	2						UCC208-24	UC208-24					
	2						UCC208-25	UC208-25					
	2						UCC208	UC208					
55	2 1/8	4.724	1 1/2	0.08	1.937	0.748	UCCX08-24	CX08	UCX08-24	34.1	21.3	14.0	2.3
	2 1/8						UCCX08	UCX08					
	2 1/8						UCC308-24	UC308-24					
	2 1/8						UCC308	UC308					
60	2 1/4	4.724	1 11/32	0.12	2.047	0.748	UCC209-26	C209	UC209-26	40.7	24.0	13.2	2.2
	2 1/4						UCC209-27	UC209-27					
	2 1/4						UCC209-28	UC209-28					
	2 1/4						UCC209	UC209					

Remarks 1. In Part No. of unit and units with covers, fitting codes follow bore diameter numbers. (See Table 10.5 in P.51.)
 2. Part No. of applicable grease fittings are shown below.
 A-1/4-28UNF 201-213, X05-X12, 305-308
 A-R1/8 309-328
 3. As for the triple seal type product (from 201 to 205 are the double seal type products), accessory code L3 (L2) follows the Part No. of unit or bearing. (Example of Part No.: UCC206JL3, UC206L3)
 4. For the dimensions and forms of applicable bearings, see the dimensional tables of ball bearing for unit.

d (45) ~ 85 mm

Shaft Dia. mm	inch	Dimensions inch mm					Unit No.	Housing No.	Bearing No.	Basic Load Ratings kN		Factor f ₀	Mass kg
		H	A	r	B	S				C _r	C _{0r}		
45	1 3/4	4.724	1 1/2	0.08	2.031	0.748	UCCX09-28	CX09	UCX09-28	35.1	23.3	14.4	2.3
	1 3/4	5.118	1 1/2	0.12	2.244	0.866	UCC309-28	C309	UC309-28				
50	1 7/8	4.724	1 19/64	0.08	2.031	0.748	UCC210-30	C210	UC210-30	35.1	23.3	14.4	2.0
	1 15/16						UCC210-31	UC210-31					
	2						UCC210-32	UC210-32					
	1 15/16						UCCX10-31	UCX10-31					
55	2	5.118	1 37/64	0.1	2.189	0.874	UCCX10-32	CX10	UCX10-32	43.4	29.4	14.4	2.8
	2						UCC310	UC310					
	2 1/8						UCC211-32	UC211-32					
	2 3/16						UCC211-34	UC211-34					
60	2 1/4	4.921	1 3/8	0.1	2.189	0.874	UCC211-35	C211	UC211-35	43.4	29.4	14.4	2.2
	2 3/8						UCCX11	UCX11					
	2 1/2						UCCX11-35	UCX11-35					
	2 3/8						UCCX11-36	UCX11-36					
65	2 3/8	5.906	1 21/32	0.1	2.563	1.000	UCC311-32	CX11	UC311-32	52.4	36.2	14.4	4.0
	2 3/4						UCC311	UC311					
	2 3/4						UCC311-35	UC311-35					
	2 3/4						UCC212-36	UC212-36					
70	2 7/8	5.118	1 1/2	0.1	2.563	1.000	UCC212	C212	UC212	52.4	36.2	14.4	2.6
	2 7/8						UCC212-38	UC212-38					
	2 7/8						UCC212-39	UC212-39					
	2 7/8						UCCX12	UCX12					
75	2 7/8	6.299	1 47/64	0.1	2.563	1.000	UCCX12-39	CX12	UCX12-39	57.2	40.1	14.4	4.6
	2 7/8						UCC312	UC312					
	2 7/8						UCC312-39	UC312-39					
	2 7/8						UCC213-40	UC213-40					
80	2 7/8	6.299	1 13/16	0.12	2.795	1.024	UCC313	C312	UC312	81.9	52.2	13.2	4.8
	2 7/8						UCC313-40	UC313-40					
	2 7/8						UCC213	UC213					
	2 7/8						UCC313-40	UC313					
85	2 7/8	5.512	1 37/64	0.1	2.563	1.000	UCC213-40	C213	UC213-40	57.2	40.1	14.4	3.0
	2 7/8						UCC213	UC213					
	2 7/8						UCC313-40	UC313-40					
	2 7/8						UCC313-40	UC313					
90	2 7/8	6.693	1 31/32	0.12	2.953	1.181	UCC314-44	C313	UC313-40	92.7	59.9	13.2	5.7
	2 7/8						UCC314	UC314					
	2 7/8						UCC314-44	UC314					
	2 7/8						UCC314	UC314					
95	2 7/8	7.087	2 3/64	0.12	3.071	1.299	UCC315-47	C314	UC314-44	104	68.2	13.2	6.7
	2 7/8						UCC315	UC315					
	2 7/8						UCC315-48	UC315-48					
	2 7/8						UCC315	UC315					
100	2 7/8	7.480	2 11/64	0.16	3.228	1.260	UCC316	C315	UC315-47	113	77.2	13.2	7.8
	2 7/8						UCC316	UC316					
	2 7/8						UCC316	UC316					
	2 7/8						UCC316	UC316					
105	2 7/8	7.874	2 23/64	0.16	3.386	1.339	UCC317	C316	UC316	123	86.7	13.3	9.2
	2 7/8						UCC317	UC317					
	2 7/8						UCC317	UC317					
	2 7/8						UCC317	UC317					

Variations of tolerance of outside diameter (ΔH_s), variations of tolerance of width (ΔA_s), and tolerance of circumferential runout of outside diameter (Y)

Housing No.		ΔH_s	ΔA_s	Y
C204-C205		0 -0.030	±0.2	0.2
C206-C210	CX05-CX08 C305-C308	0 -0.035		
C211-C213	CX09-CX10 C309-C310	0	±0.3	0.3
	CX11-CX12 C311-C314	-0.040		
	C315-C318 C319	0 -0.046		
	C320-C322 C324-C328	0 -0.052 0 -0.057		

UCC
Cylindrical bore (with set screws)
 d 90 ~ 140 mm

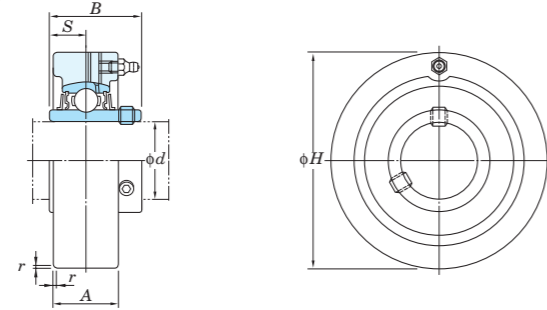

Shaft Dia. mm inch	d	Dimensions inch mm					Unit No.	Housing No.	Bearing No.	Basic Load Ratings kN		Factor f ₀	Mass kg
		H	A	r	B	S				C _r	C _{0r}		
90	3 1/2	8.858	2 19/32	0.16	3.780	1.575	UCC318-56 UCC318	C318	UC318-56 UC318	143	107	13.3	13.1
		225	66	4	96	40							
95	-	9.449	2 53/64	0.16	4.055	1.614	UCC319	C319	UC319	153	119	13.3	15.8
		240	72	4	103	41							
100	3 15/16 4	10.236	2 61/64	0.16	4.252	1.654	UCC320 UCC320-63 UCC320-64	C320	UC320 UC320-63 UC320-64	173	141	13.2	19.6
		260	75	4	108	42							
105	-	10.236	2 61/64	0.16	4.409	1.732	UCC321	C321	UC321	184	153	13.2	27.0
		260	75	4	112	44							
110	-	11.811	3 5/32	0.2	4.606	1.811	UCC322	C322	UC322	205	180	13.2	29.2
		300	80	5	117	46							
120	-	12.598	3 35/64	0.2	4.961	2.008	UCC324	C324	UC324	207	185	13.5	35.9
		320	90	5	126	51							
130	-	13.386	3 15/16	0.24	5.315	2.126	UCC326	C326	UC326	229	214	13.6	43.0
		340	100	6	135	54							
140	-	14.173	3 15/16	0.24	5.709	2.323	UCC328	C328	UC328	253	246	13.6	52.9
		360	100	6	145	59							

- Remarks 1. In Part No. of unit and units with covers, fitting codes follow bore diameter numbers. (See Table 10.5 in P.51.)
 2. Part No. of applicable grease fittings are shown below.
 A-1/4-28UNF 201~213, X05~X12, 305~308
 A-R1/8 309~328
 3. As for the triple seal type product (from 201 to 205 are the double seal type products), accessory code L3 (L2) follows the Part No. of unit or bearing. (Example of Part No. : UCC206JL3, UC206L3)
 4. For the dimensions and forms of applicable bearings, see the dimensional tables of ball bearing for unit.

Variations of tolerance of outside diameter (ΔH_s), variations of tolerance of width (ΔA_s), and tolerance of circumferential runout of outside diameter (Y)

Housing No.		ΔH_s	ΔA_s	Y
C204-C205		0 -0.030	±0.2	0.2
C206-C210	CX05-CX08 C305-C308	0 -0.035		
C211-C213	CX09-CX10 C309-C310	0	±0.3	0.3
	CX11-CX12 C311-C314	-0.040		
	C315-C318	0		
	C319	-0.046		
	C320-C322	0 -0.052	0.4	0.4
	C324-C328	0 -0.057		

UKC
Tapered bore (with adapter)
 d_1 20 ~ (50) mm

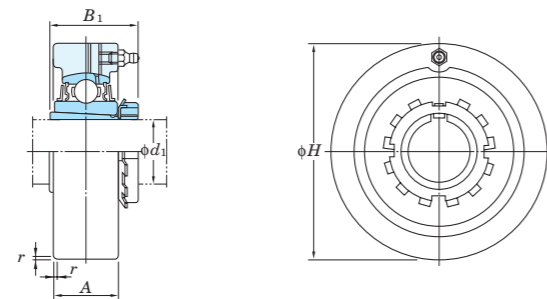

Shaft Dia. mm inch	Dimensions inch mm				Unit No.	Housing No.	Bearing No.	Basic Load Ratings kN		Factor f_0	Adapter ¹⁾ No.	Mass ¹⁾ kg	
	d_1	H	A	r				$B_1^{1)}$	C_r				C_{0r}
20	3/4	3.150	55/64	0.06	1 5/32(1 3/8)	UKC205	C205	UK205	14.0	7.85	13.9	HE305X(HE2305X) H305X(H2305X)	0.68(0.70)
		80	22	1.5	29(35)								
	3/4	3.543	1 1/16	0.06	1 3/8	UKCX05	CX05	UKX05	19.5	11.3	13.9	HE2305X H2305X	0.99
20	3/4	3.543	1 1/32	0.08	1 3/8	UKC305	C305	UK305	21.2	10.9	12.6	HE2305X H2305X	1.6
		90	26	2	35								
	1	3.346	1 1/16	0.06	1 7/32(1 1/2)	UKC206	C206	UK206	19.5	11.3	13.9	H306X(H2306X) HE306X(HE2306X)	0.85(0.89)
25	1	3.937	13/16	0.08	1 1/2	UKCX06	CX06	UKX06	25.7	15.4	13.9	H2306X HE2306X	1.3
		100	30	2	38								
	1	3.937	13/16	0.08	1 1/2	UKC306	C306	UK306	26.7	15.0	13.3	H2306X HE2306X	1.8
30	1 1/8	3.543	17/64	0.08	1 3/8(1 11/16)	UKC207	C207	UK207	25.7	15.4	13.9	HS307X(HS2307X) H307X(H2307X)	0.97(1.0)
		90	28	2	35(43)								
	1 1/8	4.331	1 11/32	0.08	1 11/16	UKCX07	CX07	UKX07	29.1	17.8	14.0	HS2307X H2307X	1.7
30	1 1/8	4.331	1 17/64	0.12	1 11/16	UKC307	C307	UK307	33.4	19.3	13.2	HS2307X H2307X	2.2
		110	32	3	43								
	1 1/4	3.937	1 3/16	0.08	1 13/32(1 13/16)	UKC208	C208	UK208	29.1	17.8	14.0	HE308X(HE2308X) HS308X(HS2308X) H308X(H2308X)	1.3(1.4)
35	1 1/4	4.724	1 1/2	0.08	1 13/16	UKCX08	CX08	UKX08	34.1	21.3	14.0	HE2308X HS2308X H2308X	2.3
		120	38	2	46								
	1 3/8	4.724	1 11/32	0.12	1 13/16	UKC308	C308	UK308	40.7	24.0	13.2	HE2308X HS2308X H2308X	2.2
40	1 1/2	4.331	1 7/32	0.08	1 17/32(1 31/32)	UKC209	C209	UK209	34.1	21.3	14.0	HE309X(H2309X) H309X(H2309X)	1.6(1.7)
		110	31	2	39(50)								
	1 1/2	4.724	1 1/2	0.08	1 31/32	UKCX09	CX09	UKX09	35.1	23.3	14.4	HE2309X H2309X	2.3
45	1 3/4	4.724	1 19/64	0.08	1 21/32(2 5/32)	UKC210	C210	UK210	35.1	23.3	14.4	HE310X(HE2310X) H310X(H2310X)	2.0(2.1)
		120	33	2	42(55)								
	1 3/4	5.118	1 37/64	0.1	2 5/32	UKCX10	CX10	UKX10	43.4	29.4	14.4	HE2310X H2310X	2.8
50	1 3/4	5.512	1 37/64	0.12	2 5/32	UKC310	C310	UK310	62.0	38.3	13.2	HE2310X H2310X	3.2
		140	40	3	55								
	1 7/8	4.921	1 3/8	0.1	1 25/32(2 5/16)	UKC211	C211	UK211	43.4	29.4	14.4	HS311X(HS2311X) H311X(H2311X) HE311X(HE2311X)	2.3(2.6)

Note 1) Numerals shown in parentheses indicate the dimensions, Part No. of applicable adapters (H2300X series), and the unit weight of UK200L3 series (triple seal type).

Remarks 1. In Part No. of unit and units with covers, fitting codes follow bore diameter numbers. (See Table 10.5 in P.51.)

2. Part No. of applicable grease fittings are shown below.

A-1/4-28UNF 205-213, X05-X12, 305-308

A-R1/8 309-328

3. In Part No. of unit with adapters and bearing with adapters, Part No. of applicable adapter follow the Part No. shown in the dimensional tables. (Example of Part No. : UKC206J + H306X, UK206 + H306X)

4. As for the triple seal type product (205 is the double seal type product), accessory code L3 (or L2) follows the Part No. of unit or bearing. (Example of Part No. : UKC206JL3 + H2306X, UK206L3 + H2306X)

5. As for the dimensions and forms of applicable bearings and adapters, see the dimensional tables of ball bearing for unit and adapter.

d_1 (50) ~ 125 mm

Shaft Dia. mm inch	Dimensions inch mm				Unit No.	Housing No.	Bearing No.	Basic Load Ratings kN		Factor f_0	Adapter ¹⁾ No.	Mass ¹⁾ kg	
	d_1	H	A	r				$B_1^{1)}$	C_r				C_{0r}
50	1 7/8	5.906	1 21/32	0.1	2 5/16	UKCX11	CX11	UKX11	52.4	36.2	14.4	HS2311X H2311X HE2311X	3.8
		150	42	2.5	59								
50	1 7/8	5.906	1 47/64	0.12	2 5/16	UKC311	C311	UK311	71.6	45.0	13.2	HS2311X H2311X HE2311X	4.1
		150	44	3	59								
55	2 1/8	5.118	1 1/2	0.1	1 27/32(2 7/16)	UKC212	C212	UK212	52.4	36.2	14.4	HS312X(HS2312X) H312X(H2312X)	2.5(2.9)
		130	38	2.5	47(62)								
	2 1/8	6.299	1 47/64	0.1	2 7/16	UKCX12	CX12	UKX12	57.2	40.1	14.4	HS2312X H2312X	4.4
60	2 1/8	6.299	1 13/16	0.12	2 7/16	UKC312	C312	UK312	81.9	52.2	13.2	HS2312X H2312X	4.7
		160	46	3	62								
	2 1/4	5.512	1 37/64	0.1	1 31/32(2 9/16)	UKC213	C213	UK213	57.2	40.1	14.4	HE313X(HE2313X) H313X(H2313X) HS313X(HS2313X)	3.0(3.3)
60	2 3/8	6.693	1 31/32	0.12	2 9/16	UKC313	C313	UK313	92.7	59.9	13.2	HE2313X H2313X HS2313X	5.8
		170	50	3	65								
	2 1/2	7.480	2 11/64	0.16	2 7/8	UKC315	C315	UK315	113	77.2	13.2	HE2315X H2315X	8.0
70	2 3/4	7.874	2 23/64	0.16	3 1/16	UKC316	C316	UK316	123	86.7	13.3	HE2316X H2316X	9.2
		200	60	4	78								
75	3	8.465	2 39/64	0.16	3 7/32	UKC317	C317	UK317	133	96.8	13.3	H2317X HE2317X	11.6
		215	64	4	82								
80	-	8.858	2 19/32	0.16	3 3/8	UKC318	C318	UK318	143	107	13.3	H2318X	13.1
		225	66	4	86								
85	3 1/4	9.449	2 59/64	0.16	3 17/32	UKC319	C319	UK319	153	119	13.3	HE2319X H2319X	16.1
		240	72	4	90								
90	3 1/2	10.236	2 61/64	0.16	3 13/16	UKC320	C320	UK320	173	141	13.2	HE2320X H2320X	19.2
		260	75	4	97								
100	4	11.811	3 5/32	0.2	4 1/8	UKC322	C322	UK322	205	180	13.2	H2322X HE2322X	29.1
		300	80	5	105								
110	-	12.598	3 35/64	0.2	4 13/32	UKC324	C324	UK324	207	185	13.5	H2324	36.2
		320	90	5	112								
115	4 1/2	13.386	3 15/16	0.24	4 3/4	UKC326	C326	UK326	229	214	13.6	HE2326 H2326	42.8
		340	100	6	121								
125	-	14.173	3 15/16	0.24	5 5/32	UKC328	C328	UK328	253	246	13.6	H2328	52.9
		360	100	6	131								

Variations of tolerance of outside diameter (ΔH_s), variations of tolerance of width (ΔA_s), and tolerance of circumferential runout of outside diameter (Y)

Housing No.		ΔH_s	ΔA_s	Y
C205		0 -0.030	±0.2	0.2
C206-C210	CX05-CX08	0 -0.035		
C211-C213	C309-C310	0	±0.3	0.3
	CX11-CX12	-0.040		
	C315-C318	0	±0.3	0.4
	C319	-0.046		
	C320-C322	0 -0.052		
	C324-C328	0 -0.057		

UCHA
Cylindrical bore (with set screws)
d 12 ~ 75 mm

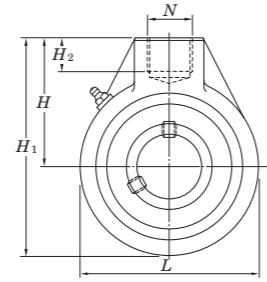
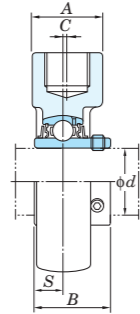

Shaft Dia. mm inch	d	Dimensions inch mm									Unit No.	Housing No.	Bearing No.	Basic Load Ratings kN		Factor f ₀	Mass kg
		H	A	L	H ₁	H ₂	N	C	B	S				C _r	C _{0r}		
12	1/2										UCHA201 UCHA201-8 UCHA202 UCHA202-10 UCHA203 UCHA204-12 UCHA204	HA204	UC201 UC201-8 UC202 UC202-10 UC203 UC204-12 UC204	12.8	6.65	13.2	0.77 0.75 0.74 0.72
15	5/8	2 17/32	1 9/16	2 17/32	3 25/32	3/4	Rp 3/4	—	1.220	0.500							
17	3/4	64	40	64	96	19	Rp 3/4	—	31	12.7							
20											UCHA205-14 UCHA205-15 UCHA205 UCHA205-16	HA205	UC205-14 UC205-15 UC205 UC205-16	14.0	7.85	13.9	0.87
25	7/8 15/16	2 17/32	1 9/16	3 1/16	4 1/16	3/4	Rp 3/4	—	1.343	0.563							
25	1	64	40	78	103	19	Rp 3/4	—	34.1	14.3							
30	1 1/8	2 17/32	1 9/16	3 1/16	4 1/16	3/4	Rp 3/4	—	1.500	0.626							
30	1 3/16	64	40	78	103	19	Rp 3/4	—	38.1	15.9							
30	1 1/4										UCHA206-18 UCHA206 UCHA206-19 UCHA206-20	HA206	UC206-18 UC206 UC206-19 UC206-20	19.5	11.3	13.9	0.83
35	1 1/4 1 5/16 1 3/8	2 3/4	1 9/16	3 5/8	4 9/16	3/4	Rp 3/4	—	1.689	0.689							
35	1 7/16	70	40	92	116	19	Rp 3/4	—	42.9	17.5							
40	1 1/2 1 9/16	2 7/8	1 9/16	3 25/32	4 3/4	3/4	Rp 3/4	5/64	1.937	0.748							
40		73	40	96	121	19	Rp 3/4	2	49.2	19							
45	1 5/8 1 11/16 1 3/4	3 7/32	1 7/8	4 1/4	5 11/32	13/16	Rp 1	13/64	1.937	0.748							
45		82	48	108	136	21	Rp 1	5	49.2	19							
50	1 7/8 1 15/16	3 9/32	1 7/8	4 21/32	5 19/32	13/16	Rp 1	13/64	2.031	0.748							
50		83	48	118	142	21	Rp 1	5	51.6	19							
55	2 2 1/8 2 3/16	3 7/16	2 3/8	4 31/32	5 29/32	31/32	Rp 1 1/4	9/32	2.189	0.874							
55		87	60	126	150	25	Rp 1 1/4	7	55.6	22.2							
60	2 1/4 2 3/8 2 7/16	4 1/32	2 3/8	5 19/32	6 13/16	1 3/32	Rp 1 1/4	23/64	2.563	1.000							
60		102	60	142	173	28	Rp 1 1/4	9	65.1	25.4							
65	2 1/2	4 19/32	2 3/4	6 17/32	7 7/8	1 1/4	Rp 1 1/2	3/8	2.563	1.000							
65		117	70	166	200	32	Rp 1 1/2	9.5	65.1	25.4							
70	2 3/4	4 19/32	2 3/4	6 17/32	7 7/8	1 1/4	Rp 1 1/2	3/8	2.937	1.189							
70		117	70	166	200	32	Rp 1 1/2	9.5	74.6	30.2							
75	2 15/16 3	4 19/32	2 3/4	6 17/32	7 7/8	1 1/4	Rp 1 1/2	3/8	3.063	1.311							
75		117	70	166	200	32	Rp 1 1/2	9.5	77.8	33.3							

Remarks 1. In Part No. of unit and units with covers, fitting codes follow bore diameter numbers. (See Table 10.5 in P.51.)
 2. Part No. of applicable grease fittings are shown below.
 A-1/4-28UNF 201-210
 A-R1/8 211-215

3. As for the triple seal type product (from 201 to 205 are the double seal type products), accessory code L3 (or L2) follows the Part No. of unit or bearing. (Example of Part No. : UCHA206JL3, UC206L3)
 4. For the dimensions and forms of applicable bearings and adapters, see the dimensional tables of ball bearing for unit and adapter.
 5. Tapered bore (with adapter) type products are also available. (Example of Part No. : UKHA205J + H305X, UK205 + H305X)